

**Fig No: FPC-1500**

**1/2" ~ 2" DN15 ~ DN50**

**Features :**

Forged steel check valves are available in three bonnet designs. The first design is the Bolted Bonnet, With male-female joint, spiral wound gasket, made in F304L/graphite. Ring joint gasket are also available on request. The second design is the welded bonnet, with a threaded and seal welded joint, On request a full penetration strength welded joint is available. The third design is the pressure seal bonnet, with a threaded and pressure seal bonnet joint.



**Check valve Design Construcion and Specifications :**

Check vales conform to MSS-SP-118 and ASME B16.34.

Each are tested according to API598

Marking is per MSS SP-25.

**Construciton is as follows :**

Full Port or Conventional Port

Piston check

Spring available on request

Socket weld Ends to ASME B16.11

Screwed Ends (NPT) to ANSI/ASME B1.20.1

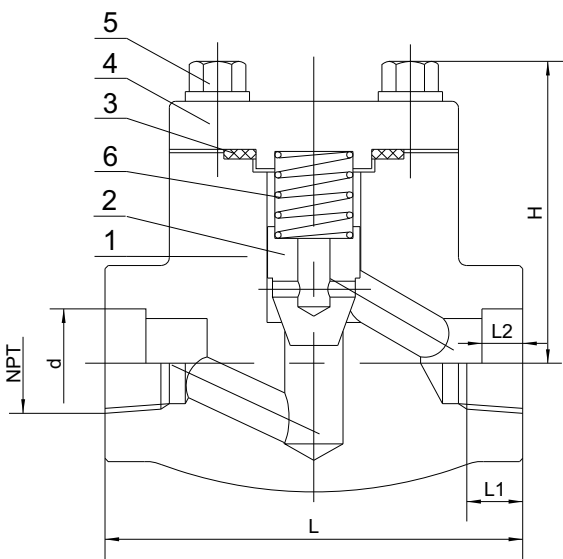

**DIMENSIONS**

unit:mm

NPS	d	L2	NPT	L1	L	H
1/2	21.8	10	1/2	15	111	82
3/4	27	13	3/4	18	111	82
1	34	13	1	18	120	110
1-1/4	42.5	13	1-1/4	19	152	120
1-1/2	48.5	13	1-1/2	19	172	130
2	61	16	2	25	220	150

**MATERIALS LIST**

NO	Name	MATERIAL		
1	BODY(SEAT)	A105+ER410	F304(L)	F316(L)
2	PISTON DISC	A182 F6	F304(L)	F316(L)
3	GASKET	F304+GRAPHITE	F316+GRAPHITE	
4	BONNET	A105	F304(L)	F316(L)
5	BOLT	A193 B7	A193 B8	
6	SPRING	F304	F316	

Other Materials Also Available On Requested